

Technical Bulletins

Safety R10– Sheet Vinyl Flooring



Safety R10 is a commercial grade, smooth hygienic vinyl floor incorporating a chip effect (marbling) pattern that is even in both directions of the roll plane.

Safety R10; Highly Durable, Commercial Grade Safety Sheet Vinyl Flooring

Roll Size; 2m x 20m x 2mm thick

Intended use:

- Healthcare
- Food industry, Restaurants fast food, hotels, back-of house
- Change rooms
- Child care
- Housing
- Restrooms
- Ablutions

Performance:

- Fire safety: Pass when tested to ISO9239-2010, Critical radiant Flux 7.54 KW/m²;
- Slip Resistance: R10 slip resistance

Adhesives & Sub-Floor Preparation Materials

Adhesives;	Duracryl, HSV, Supacryl, Supatack T9 or Truestik VA1.
Smoothing compound:	allnex feather finish
Levelling compounds:	FLC, Durabond Superfine,
Floor Repairs;	Supaset, Screed 20+

Section 1.0 Installation.

- Ideally the vinyl sheets must unrolled and kept in ambient conditions in the area to be installed in advance of the installation, this will relax the vinyl sheeting and assist with allowing the vinyl to lay flat on the floor during installation. If this is not practicable to store the vinyl on site, ensure the vinyl is pre conditioned off site, the recommended minimum temperature is 18°C, achievable with normal heating.
- Trim roll edges if / when appropriate.
- Ensure the adhesive is also conditioned prior to application, all acrylics must be applied at ambient temperature to obtain maximum adhesion. Application in cold or excessively hot temperatures can lead to the adhesive not setting or setting too quickly resulting in either a poor / no bond, or gassing where bubbling may occur.
Apply the adhesive with a V1 or U1 notched Versa trowel blade, Ensure the required quantity of adhesive is applied, too much adhesive will delay the drying time and cause bubbling, insufficient adhesive will also cause bubbling, excessively cold conditions will delay drying and also most likely result in bubbling.

- Carry out vinyl installation,
As applying smooth down the vinyl manually then roll with a 68kg roller, to ensure complete contact with the underside of the vinyl and the floor adhesive is achieved.
If required, Reverse the direction of adjacent rolls
CHECK – before doing so, check that this gives the best aesthetic match.

Lay without reversing if that is a better match.
- Thermo welding of the seams, this should only be carried out after a minimum of 24 hours after installation, if thermo welding is undertaken while the adhesive is still wet the heat from the welding process will create boiling of the adhesive resulting in contamination of the edges of the vinyl which in turn will lead to a failed weld.
- Use a P Type Groover for forming the routed seams this will create a U shape seam and should be routed out to a depth of 1.5mm of the thickness of the vinyl.
- Use an Anti-Glaze speed weld tip to carry out the welding process, this concentrates the heat into the formed seam and reduces heat spillage onto the surface of the leading edges of the vinyl which if happens will show as a glaze line on the seam.
- Trimming of the weld rod should only be undertaken after the seam has cooled. If trimmed too early then shrink back of the rod will occur resulting in a depression in the seam which will become a dirt trap.
- Finishing strips Cove Strip 5.2mm or allnex PVC Wall Capping; install true and level mechanically fix to the wall surface, mitre all internals, external, fit before laying the vinyl.
- Coved upstands; use a preformed cove former “Flexicove 28mm” or pencil cove.
The use of a cove former supports the vinyl at the floor wall junction and allows easier cleaning of the otherwise tight radius of the pencil cove.
- Following the Installation of the body of the floor,
adhesive is applied to the cove and wall upstand,
allow the adhesive to set up “Becomes Tacky”
Heat the back face of the vinyl with a hot air gun
smooth the vinyl into place, trim fit at the correct angle to ensure the vinyl is held behind the front edge of the cove strip, apply pressure to the wall surface and cove area with a stainless steel cove roller. If the vinyl is not positioned fully into the cove strip then gaps will occur and pressure on the cove area may allow the vinyl to become detached from the wall surface
Thermo weld all internal and external corners.

Floor protection such as pattern scribe paper should be used to protect the vinyl floor surface prior to the floor cleaning programme; this will reduce the amount of initial cleaning required before the application of the polish system

Allow the floor to fully dry and settle before allowing traffic and furniture to be replaced.

Cleaning & Maintenance

It is not recommended to apply polish to safety vinyl.

Do not use detergents using Pine oil.

Sweep and vacuum up dust and debris prior to cleaning as shown below.

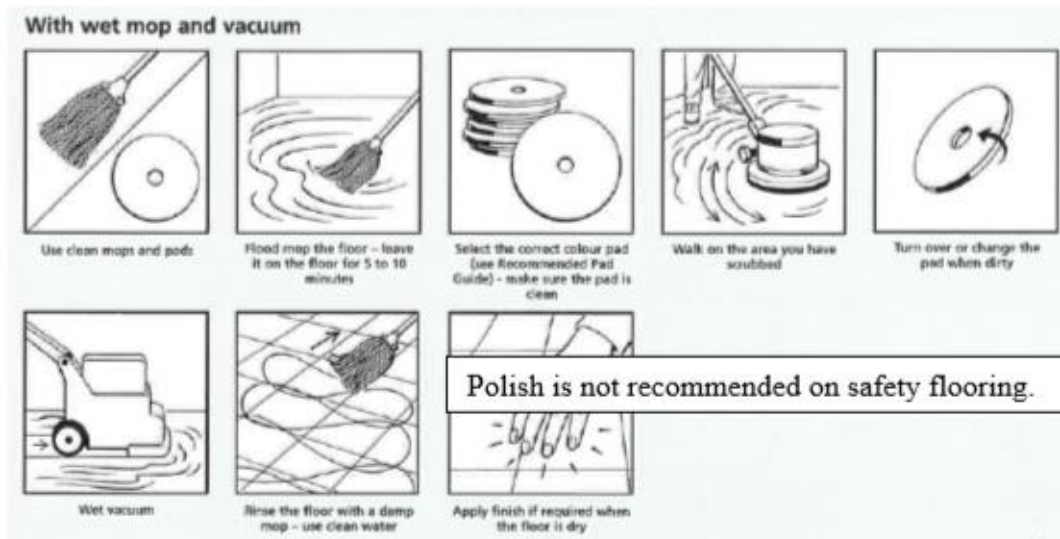

Free Ph 0508-882288

Free Fax: 0508-553344

For all data, please refer to our website. www.allnexconstruction.co.nz

Date: Aug 2019

Replaces August 2017

Allnex Construction Products, a Division of Allnex New Zealand Ltd

Auckland - 14 Industry Road Penrose phone: 095836544. Hamilton - 18 Somerset Street Frankton phone: 07-847-8658

Wellington - 19A Jamaica Drive Grenada North phone: 04-240-0305. Christchurch - 112 Carlyle Street Sydenham phone: 03-366-6802

Customer Service: 0508-882-288 cs.constructionnz@allnex.com

www.allnexconstruction.com

DISCLAIMER: This information appearing in this Document (**Details**) concerning the product which is the subject of the Document (**Product**) is either based on present technical knowledge and tests done by allnex or tests done by, and data supplied from third parties including you, the customer. Since the actual use by you and by others of the Product is beyond the control of allnex, no warranty or representation, express or implied is made by allnex regarding the suitability for such use, nor does allnex accept any liability arising out of the use by you of other products or materials, whether third party or not, that may be referred to in this Document. allnex recommends that you carry out your own tests as to the suitability of the Product for your purpose, regarding which you accept full responsibility. In addition, if any of the Details appearing in the Document are based upon tests done by, and/or data supplied by any third party, allnex provides no warranties or representations in connection with those Details and you, the customer waives any right you may have against allnex in connection with the accuracy, completeness or otherwise of the Details. The information in this Document is not to be construed as absolutely complete or accurate since additional information may be necessary or desirable when particular or exceptional conditions or circumstances exist or because of applicable laws or government regulations affecting use of the Product. allnex does not provide any warranty or representation to you that the Product does not infringe the intellectual property rights of any third party. All orders accepted shall be subject to the standard conditions of sale of allnex which are on the back of our invoice. In accepting the Product you, the customer acknowledge and agree: **a.)** The Product is or may be of a hazardous nature and that you, the customer, are responsible for the disposal of the container housing the Product in accordance with the requirements and regulations of the relevant supervising government. **b.)** The Product has a limited shelf life and must be stored strictly in accordance with the guidelines and specifications related to it. **c.)** Where the Details relate to Product tested by allnex, those Details are indicative only, regarding which there may be batch to batch variation. **d.)** allnex gives no warranty or representation as to the applicability for the particular use by you, the customer, of the Product and you the customer shall be responsible for ensuring that the Product is fit for your intended use. **e.)** allnex's liability for breach of any term, condition, guarantee or warranty (express or implied and concerning the information in this Document or the Product more generally) including any liability for direct or indirect consequential loss (including indirect loss of profits), is limited to the maximum extent permitted by law and, at allnex's election, to either replacing or repairing the goods or paying the cost of replacing or repairing the goods, or in the case of services, supplying the services again.