

## Primer B1 & B2, Bituthene® Mastic

A functional range of essential ancillary products which contribute to the successful application of Grace waterproofing systems.

### Features

#### Primer B1 & B2

- Provides a tack coat - promotes bonding of Bituthene and bituminous sealants to horizontal and vertical surfaces.
- Good coverage - 6 to 8 sq m per litre depending on surface porosity.
- Easily applied - by brush or roller.
- Moisture tolerant primer system - Primer B2 allows application in damp or marginal weather conditions.

#### Bituthene Mastic

- Cold applied - ready to use mastic for sealing around irregularities, pipes and membrane termination chases.
- Simple application - trowel or gun applied into primed chases.

### Applications

Primer B1, Primer B2 and Bituthene Mastic have been designed to complete the range of Grace waterproofing systems.

When using Bituthene membranes it is essential to have a comprehensive range of ancillary materials which contribute to the watertightness of the overall membrane

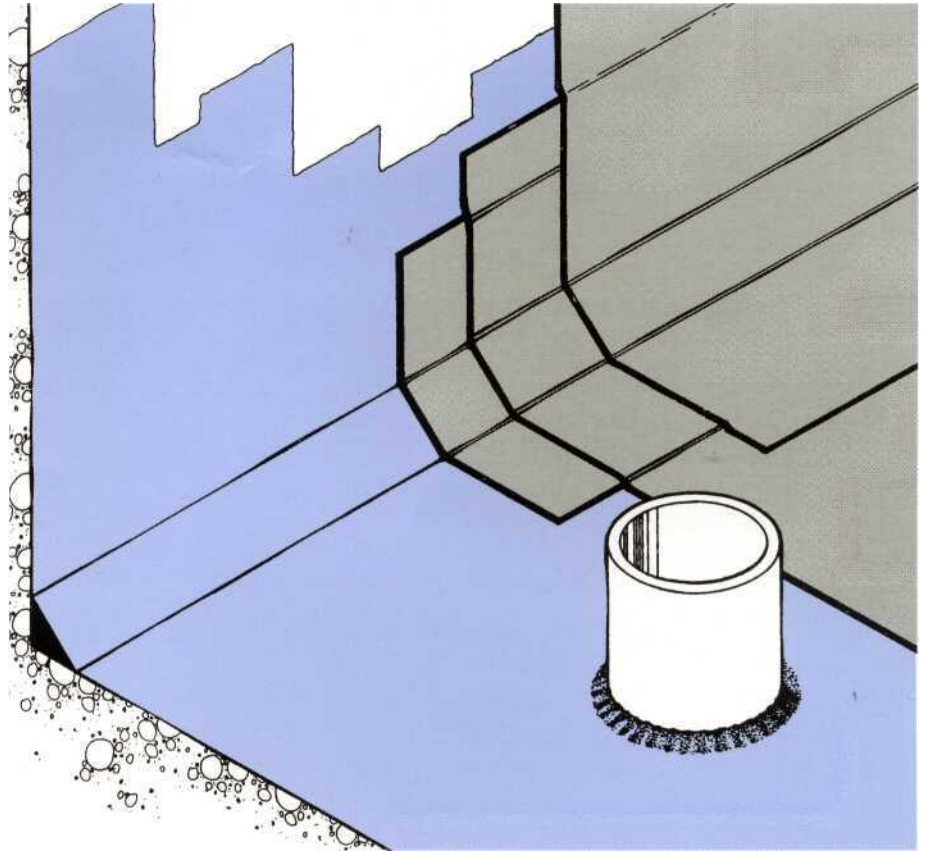

system. These supplementary materials assist with the application by solving small detailing problems and provide the vital elements which complement the system.

## Primer B1 & B2

Primer B1 & B2 are one part solvent borne bituminous primer and should be used to condition concrete and other surfaces to promote the adhesion of Bituthene self-adhesive membranes. They should also be used to prime sealant chases prior to sealing with Bituthene Mastic.

### Supply

Primer B1	18.2 litre pails
Coverage	6-8 sq metre per litre depending on method of application, surface texture, porosity and ambient temperature
Primer B2	25 litre pail
	8-10 m <sup>2</sup> /litre coverage

### (Damp Surface)

Storage	Dry conditions below +25°C
---------	----------------------------

### Ancillary Material

Tool Cleaner	5 litre can
--------------	-------------

### Equipment by Others

Soft brush or natural fibre roller for applying Primer, stiff broom and airline for cleaning surfaces.

### Installation

Do not use below -5°C. At air temperatures between -5°C and +4°C measures should be taken to ensure that surfaces are free from ice, frost or condensation.

Surfaces should be dry, flat, free of sharp protrusions and hollows. Use a stiff broom and airline to remove dust and all contaminants.

A single coat of Primer should be applied by brush or roller, brushing/rolling out well to give a thin even coat. The Primer must not be poured on to surfaces and care should be taken to avoid ponding in depressions. Allow a minimum drying period of 1 hour ensuring primer is completely dry before receiving membranes or bituminous sealants. For priming large areas a roller will prove most effective. Clean tools and equipment with mineral spirits.

## Bituthene Mastic

Bituthene Mastic is a cold applied one part solvent based bituminous mastic used to seal Bituthene membranes around irregularities, pipes and obstructions. It can also be used in membrane termination chases which are below ground or not exposed to the elements.

### Supply

Bituthene Mastic 3 litre can, 850cc tubes

### Storage

Keep in sealed containers below +25°C away from sources of ignition.

### Equipment by Others

Trowel or Spatula, Caulking Gun

### Installation

Do not use below +4°C.

Surfaces should be dry, flat, free of sharp protrusions and hollows. Use a stiff brush and airline to remove dust and all contaminants.

Use a trowel or spatula to scoop mastic from can and apply into previously primed joints and corners, compacting mastic well to avoid air entrapment.

Clean tools and equipment with mineral spirits.

## Health and Safety

Refer to relevant Material Safety Data Sheets.

## Specification

Primer B1, Primer B2 (... grade) and Bituthene Mastic (... grade) shall be applied strictly in accordance with the manufacturer's instructions and supplied by Grace Construction Products. For further information contact your local Grace representative.



Bituthene is a registered trademark of W. R. Grace & Co.-Conn.

The information given is based on data and knowledge considered to be true and accurate and is offered for the user's consideration, investigation and verification. Since the conditions of use are beyond our control we do not warrant the results to be obtained. Please read all statements, recommendations or suggestions in conjunction with our conditions of sale including those limiting warranties and remedies which apply to all goods supplied by us. No statement, recommendation or suggestion is intended for any use which would violate or infringe statutory obligations or any rights belonging to a third party.

These products may be covered by patents or patents pending. Copyright 2002. W R Grace (S) Pte Ltd. Ref. DS-23B Printed in Singapore 01/02

**GRACE**  
Construction Products